



Soil Erosion and Sedimentation Control PLAN OPTIONS

The Town of Southern Pines Soil Erosion and Sedimentation Control Chapter requires that the minimum erosion control measures, as outlined in Section 154.07 (A), be installed when the disturbed area on a tract of land is less than thirty-thousand square feet (30,000 SF), *unless otherwise exempt from installation of measures/devices or ESC Plan Approval is required.* Furthermore, no person shall initiate any land-disturbing activity on a tract if more than thirty-thousand square feet (30,000 SF) is to be uncovered unless, thirty (30) days or more prior to initiating the activity; a Plan for such activity is filed with and approved by the Town. Failure to install and/or maintain erosion control measures/devices may result in penalties of up to \$5,000.00 per day.

INSTRUCTIONS:

Identify One or Any Combination of Letters for the Schematic That Best Describes the Erosion Control Measures That Will be Used at Your Site During Construction.

LEGEND:

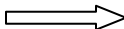
-  SILT FENCE
-  CONSTRUCTION ENTRANCE
-  DIRECTION OF FLOW (POINT DOWNHILL)

A. Flow to the Rear

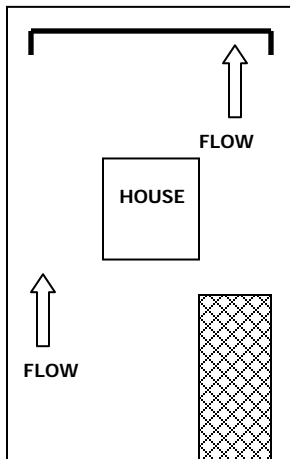

B. Flow to the Front

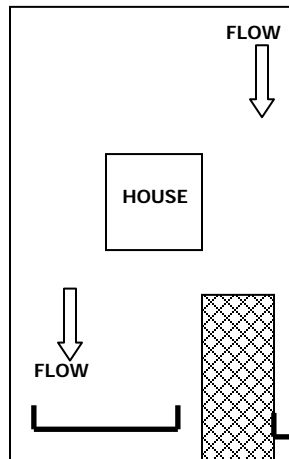

C. Flow to the Left

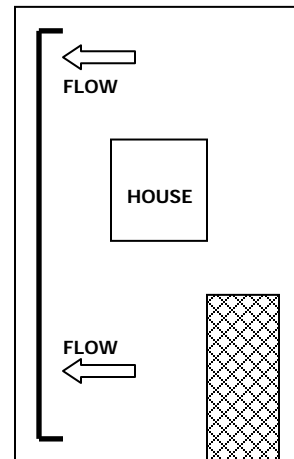

D. Flow to the Right

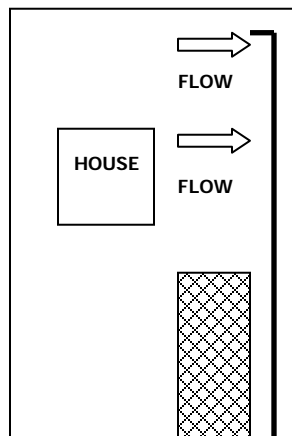

E. Flow to the Front & Rear

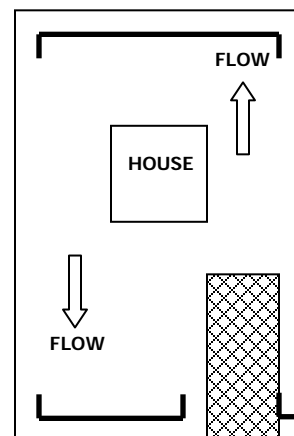



SOIL EROSION and SEDIMENTATION CONTROL

COMPLIANCE FORM

(Tracts less than thirty-thousand square feet (30000 SF) land disturbance) Residential and Commercial

(A) Minimum Erosion Control Measures Required, Unless Otherwise Approved.

The approved and minimum required erosion control measures to be placed on an individual residential or commercial construction site that is less than thirty-thousand square feet (30,000 SF) in surface area are:

- (1) A construction entrance,
- (2) Silt fencing on all lower elevation perimeters, and
- (3) Established groundcover.

The site must comply with the Town's Soil Erosion and Sedimentation Control Chapter by installing and maintaining all required controls measures as indicated on permit approval.

The only land disturbing activity to take place before the erosion control measures are completed is the cutting of trees and/or vegetation necessary to install the erosion control measures and/or devices.

If it is determined that: a significant risk of accelerated erosion exist; off-site sedimentation may occur as a result of the land-disturbing activity; and/or other conditions exist that require the preparation and approval of a Plan and that a grading permit be secured for land-disturbing activity of areas less than thirty-thousand square feet (30,000 SF), the Compliance Form is not valid.

(B) Compliance Procedure.

The property owner shall notify the Town of Southern Pines Construction Inspector to schedule an inspection of the ESC measures required. If the erosion control measures are not installed by the scheduled footing inspection and/or the Construction Inspector observes any erosion control problems on the site, including, but not limited to, failure to install erosion control measures, a written Notice of Violation will be issued in accordance with Section 154.17 (C). The footing inspection or any subsequent inspection approval will not be rendered until all control measures are in place and functioning.

(C) Final Inspections.

When all construction on the project is complete, call the Construction Inspector to schedule an inspection. The inspection will evaluate the site and all permanent erosion control features and off-site impacts to other properties, if applicable. If found to be in compliance, the Building Inspector will be advised, giving approval for the Certificate of Occupancy.

A Soil Erosion and Sedimentation Control Compliance Form, indicating the minimum control measures to be installed at the site, must be completed before a building permit can be issued, unless otherwise approved.

APPROVAL PROCESS:

- 1. Pick up an ESC Compliance Form, along with other application forms such as Water and/or Sewer Service and Driveway Permit, at Town offices or web site www.southernpines.net.
- 2. Complete and submit to Public Works Department located at 140 Memorial Park Court.
- 3. The Erosion Control Office will review / approve / comment on the application.
- 4. The original approved ESC Compliance Form will be returned to the applicant with a copy to be filed with Building Inspection Department.
- 5. The Building Permit holder shall prominently display the approved SESC Compliance Form at the entrance to the construction site until the project is complete.
- 6. Attachments:
 - * ESC Compliance Form.
 - * Construction Details for installation of Temporary Construction Entrance & Temporary Silt Fence.